

# 500VSK/VSH/ESK/ESH series

Fast acting fuse – Suitable for industrial machinery and PV

## Features

- ◇ Fast acting and durable
- ◇ Useable with both AC and DC
- ◇ Compact body size with  $\phi 6.6 \times 25\text{mm}$  at 500V-40A rating
- ◇ Compact size enables smaller printed board use for servo, power conditioners and inverters.



## Specifications

### VSK (Board soldered type)

### VSH (Screw installation type)

<Rated voltage & Breaking capacity>

AC500V-1kA

DC500V-1kA (Resistance circuit)

DC450V-10kA (L/R=1ms)

UL recognized : AC/DC450V

CCC recognized (under application) : AC400V, DC350V

<Minimum breaking current>

2 times the rated current (DC450V, L/R=0.1ms)

### ESK (Board soldered type)

### ESH (Screw installation type)

<Rated voltage & Breaking capacity>

DC500V-1kA (Resistance circuit)

DC450V-10kA (L/R=1ms)

<Minimum breaking current>

5 times the rated current

Type	Rated current (A)	Pre-arc $I^2t$ ( $A^2S$ )	Total $I^2t$ at DC450V-10kA	Watts-loss (W)	Weight (g)	Standard approved
500VSH10 500VSK10	10	49	110	0.8	3.9	  Under application
500VSH20 500VSK20	20	125	280	3.0		
500VSH36 500VSK36	36	400	900	10.0	2.7	 Under application
500ESH40 500ESK40	40	1380	3000	6.0		

\* Quotes available  
\* Now accepting sample orders

## Pre-arcing time-current characteristics

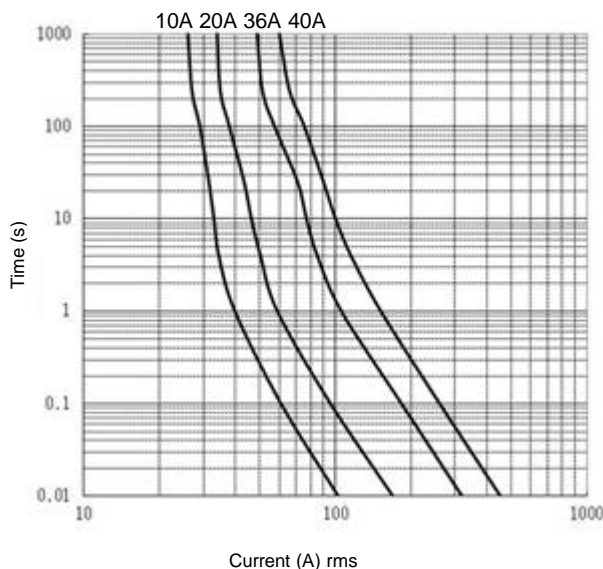

## Dimensions (mm)

### 500VSH/ESH

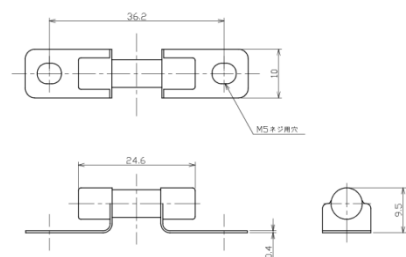

### 500VSK/ESK

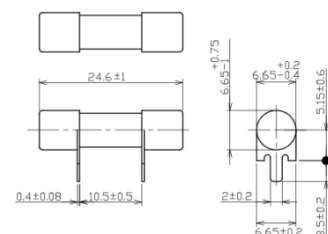

For inquiries, please contact our sales department at;

Tel: 03-3860-8661 Fax: 03-3860-8660 E-mail: [uketsuke@hinodedenki.co.jp](mailto:uketsuke@hinodedenki.co.jp)

All specified data in this leaflet is based on available information at the time of publication, and the products and/or specifications may be subject to change without notice. We recommend that all our customers check the latest product information on our web site (<http://www.hinodedenki.co.jp>) as well as contacting us before placing orders.